

# ECOUSTIC® TIMBER CEILING BLADE INSTALLATION & CARE



unika vaev  

---

INSTYLE

Hear yourself think®

# ECOUSTIC® TIMBER CEILING BLADE INSTALLATION & CARE

## Ceiling Tile Installation

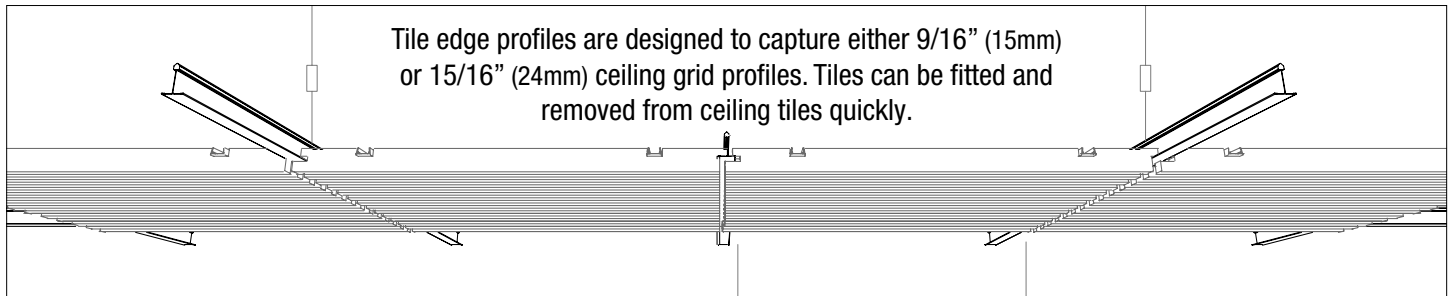

### Supplied by Unika Vaev

Ecooustic® Timber Ceiling Blade is supplied in the following quantities:

- 24 Tile (23 5/8" x 23 5/8"): 8 tiles per box
- 48 Tile (47 1/4" x 23 5/8"): 4 tiles per box

### Ceiling Grids

Unika Vaev does not supply ceiling grid systems.

Ecooustic® Timber Ceiling Blade can be used in any standard proprietary ceiling grid systems.

Unika Vaev recommends using ceiling grids in black finish color to complement Ecooustic® Timber Ceiling Blade tiles.

The total weight per m2 of all Ecooustic® Timber Ceiling Blade is within the maximum weight rating of most grid systems. New ceiling grids must be installed to comply with manufacturer's specifications. When using existing ceiling tile grids, installers must confirm the structural adequacy of the grid and install additional grid hangers as required to meet structural engineer's specifications.

Structural engineers safety certification must be confirmed for all overhead installations.

### Ecooustic® Infill

Where Infills are used and tiles are to be removed, care needs to be taken that the infill is secured to the tile to avoid injury.

## INFILL ASSEMBLY INSTRUCTIONS

**Step 1:** Rest Ecooustic® Timber Blade tile within suspended ceiling grid.

**Step 2:** Use access from adjoining ceiling grid open area to place Ecooustic® Infill panels over installed Timber Blade tiles.

**Step 3:** Rest Ecooustic® Infill panels over Timber Blade tile, ensuring the Infill is located within suspended ceiling grid T bars

Please Note: Hold or secure Infill panel to final Blade tile to be installed within a ceiling space

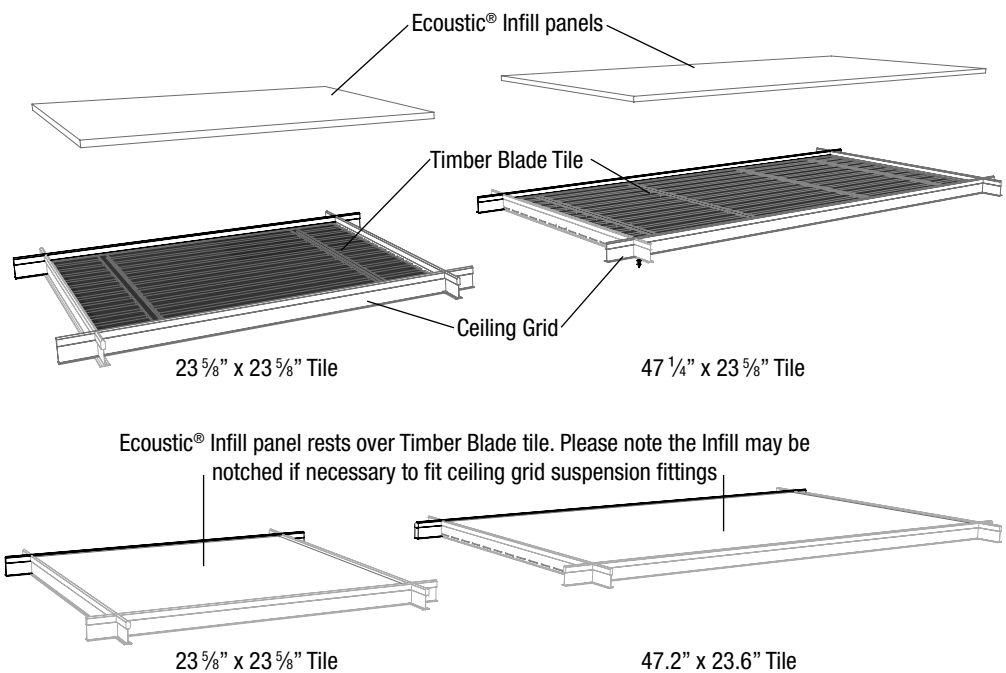

# ECOUSTIC® TIMBER CEILING BLADE INSTALLATION & CARE

## Light Fitting Installation

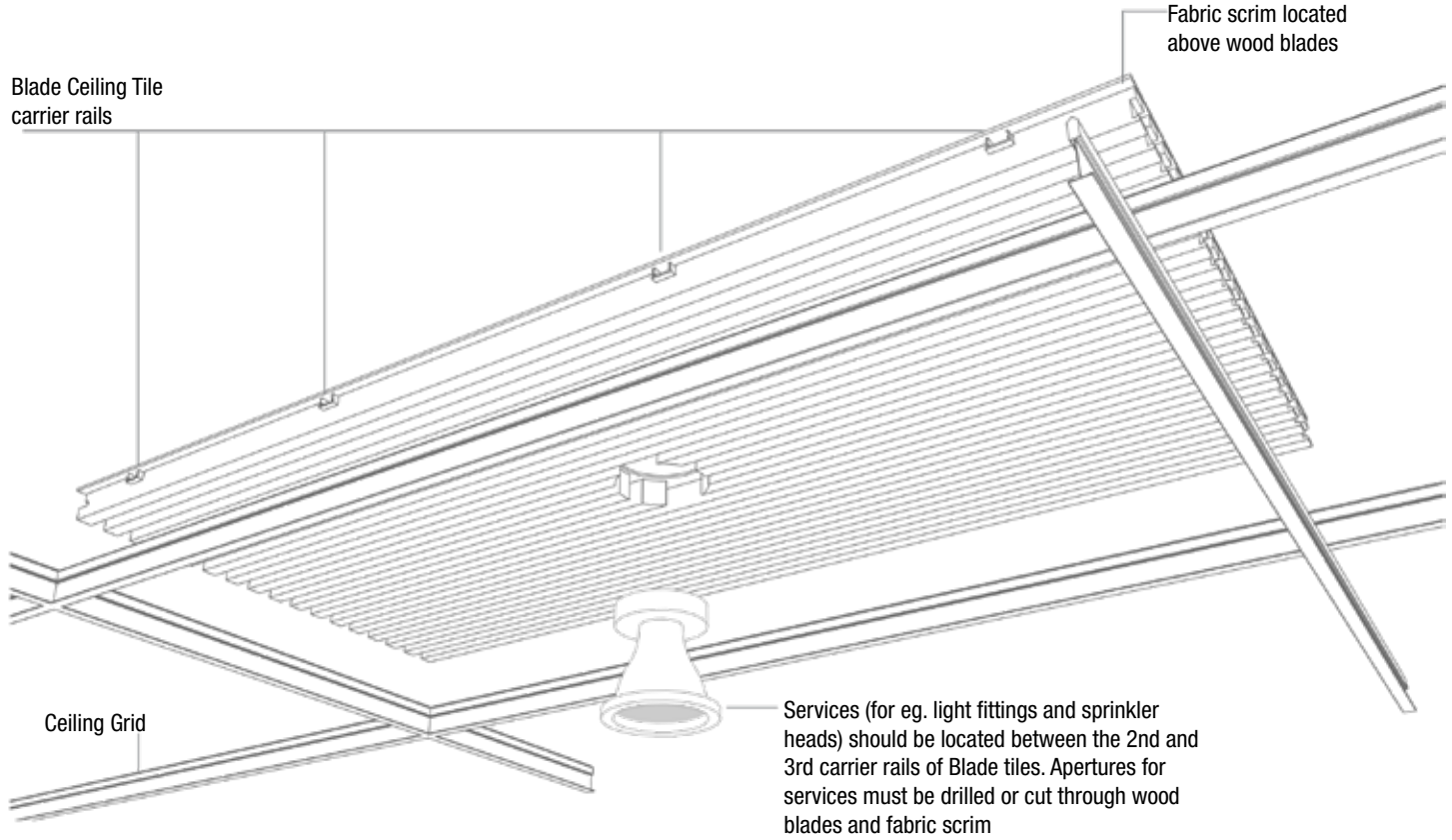

## Angular Ceiling Installation

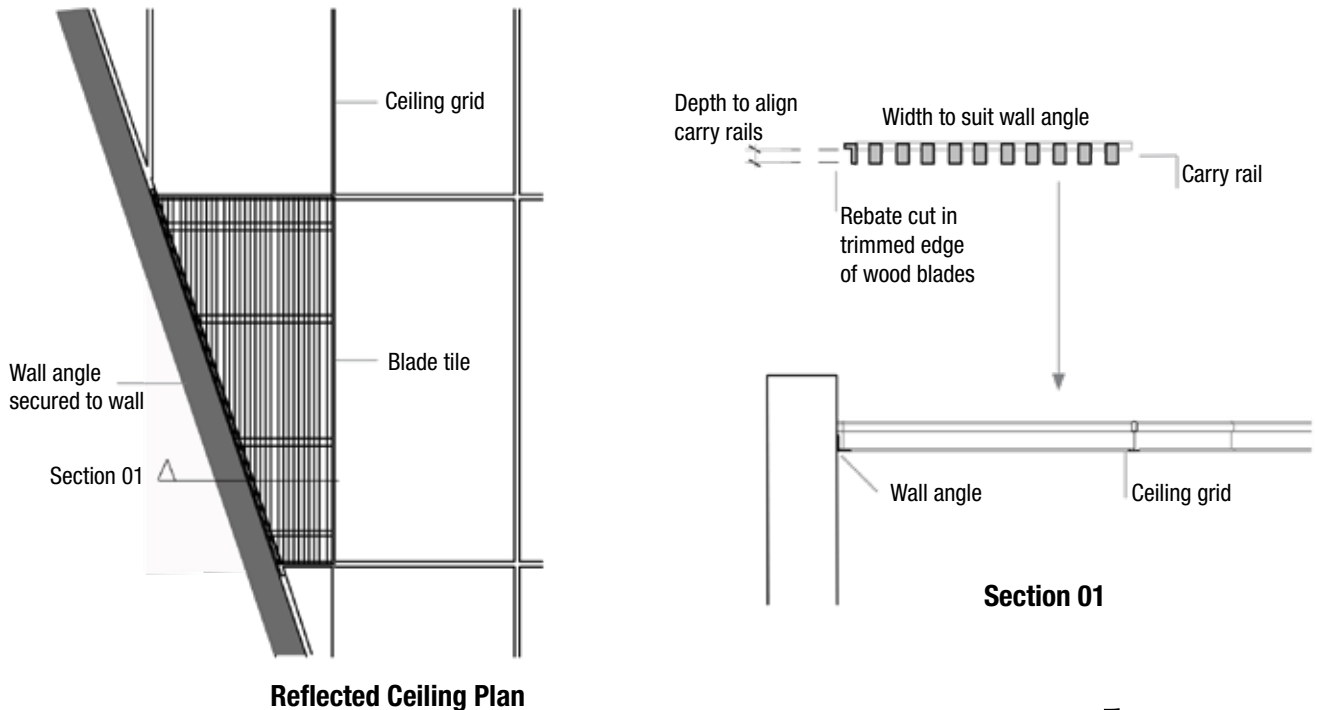

# ECOUSTIC® TIMBER CEILING BLADE INSTALLATION & CARE

## Angular Ceiling Installation Continued

View 1 (From Below)

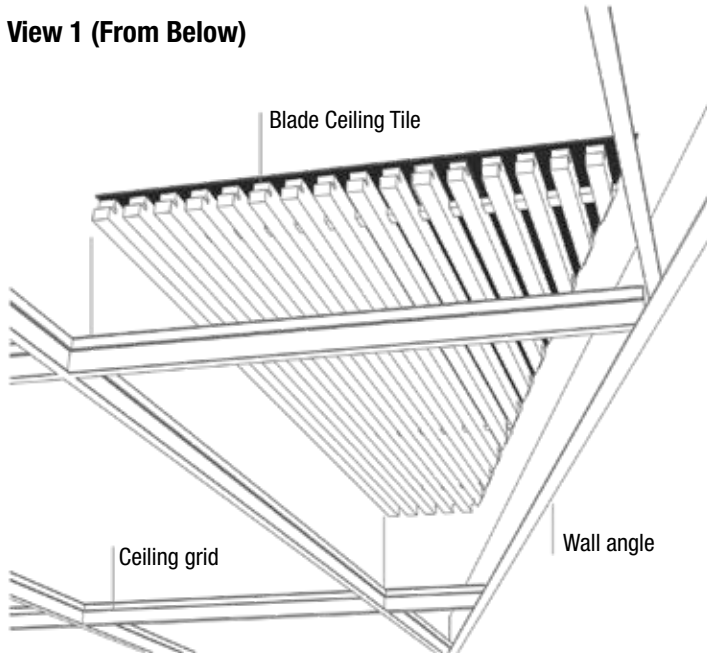

Measure the edge triangular tiles on site, and cut the Blade Ceiling Tile + Scrim fabric over the blades as needed to align the hypotenuse of the triangle shape.

View 2 (From Above)

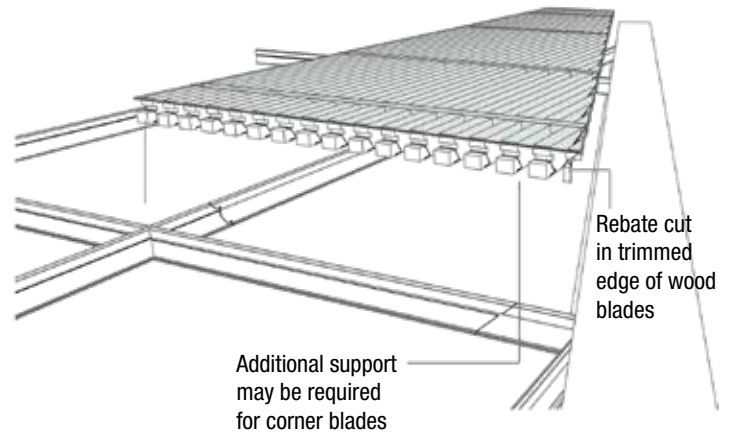

Cut a rebate in the hypotenuse of the tile blades, such that the rebate height will align the level of blade tile carrier rails, and the rebate width will align the edge of intended Blade tile hypotenuse support (wall angle or ceiling grid).

View 3 (From Above)

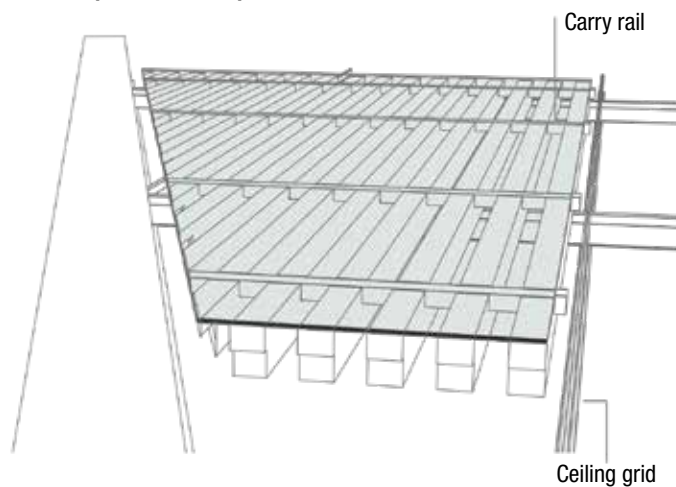

Check tolerances and apply desired finish to the cut wood surfaces.

Please Note: it may be necessary to provide additional support to any blades not supported by carry rails. This could be achieved from above the scrim fabric via mechanical fasteners through discarded sections of carry rail or similar.

# ECOUSTIC® TIMBER CEILING BLADE INSTALLATION & CARE

## Care

Ecoustic® Timber Blade ceiling tiles + panels are pre-finished in internal grade coatings therefore periodic dusting should keep the tiles looking their best.

Should the tiles require cleaning, we recommend wiping the tiles down with a clean dry or damp cloth or duster.